



1.0 Know your aircraft

The main structure of the ABS material, the new industrial and modular design, improve product development, easy installation and maintenance, replacement upgrades.

Equipped with FPV 5.8G map transmission real-time transmission system, bring you not the same visual effects.

1. Aircraft shell
2. Cover the screw hole
3. FPV system
4. EVA pad (fixed camera)
5. Rack
6. Rack cap screw hole
7. Forward rotation propeller
8. Reversing the propeller
9. Propeller guardrail
10. Body battery compartment
11. Battery

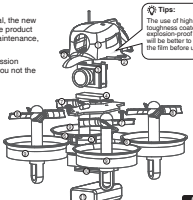

Tips:
The use of high toughness material will be better to use than the before view

2.0 parameters

Crash parameter

Main wing length: 66mm
Size: 83.8x51.4x2.2mm
Weight: 20g(without battery)
Motor: 6015 15 brush motor
Lipo battery: 3.7V 200mAh 5SC
Flight time: 5min
Omnidirectional reception antenna
Working temperature: 10°C to 40°C

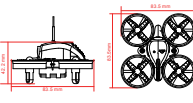

Frequency Table	Unit:MHz									
	CH1	CH2	CH3	CH4	CH5	CH6	CH7	CH8		
Band 1	5865	5845	5825	5805	5785	5765	5745	5725		
Band 2	5733	5752	5771	5790	5809	5828	5847	5866		
Band 3	5705	5685	5665	5645	5625	5605	5585	5565		
Band 4	5740	5760	5780	5800	5820	5840	5860	5880		
Band 5	5658	5695	5732	5769	5806	5843	5880	5917		

4.0. remote control

4.1 Remote control function introduction

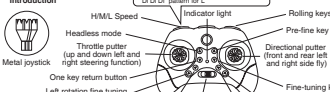

4.2 Remote control battery installed

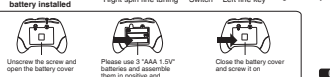

AGES 14+

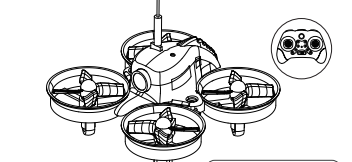

FPV six-axis aircraft operating instructions

Tips: Please charge before use!

1.1 The architecture of the aircraft

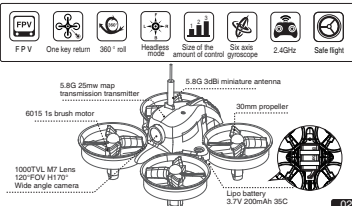

3.0 Frequency method

FPV system :5.8G 40CH
See Table 3 on the frequency table

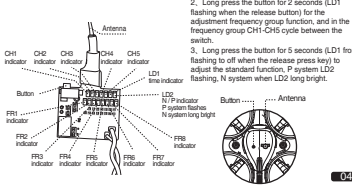

Key functions:

1. Short press the button to adjust the frequency function, and at the frequency FR1-FR8 cycle between the switch.
2. Long press the button for 2 seconds (LD1) flashing when the release button for the adjustment frequency group function, and in the frequency group CH1 cycle between the switch.
3. Long press the button for 5 seconds (LD2) flashing of all when the release press key to adjust the standard function, P system LD2 flashing. If system enter LD2 long press.

6.2 Gyroscope preloading

After the completion of the code, the aircraft placed in the horizontal position. Push the two joysticks at the same time to the lower right corner 45° for gyro calibration. LED lights flash quickly, preloading is complete.



Tips: Before the aircraft take off, be sure to place the aircraft in the horizontal plane preloading, to ensure that the aircraft after the smooth flight. When the aircraft by the impact or collision after the deviation, you can also use this method to calibrate the gyroscope.

7.0. Operation and control

7.1 mode of operation

As sensitive, for beginners, it is recommended to slow operation of the rocker. Such as the operation of the aircraft during the process of a slight decline, but also slowly push the left rocker to climb to a certain height. Operation to avoid a significant push of the throttle.

7.2 Operation mode

Aircraft movement fine-tuning
Slowly raise the throttle stick, when the aircraft to leave the ground. If the aircraft is tilted to different directions, you can use fine-tuning control action.

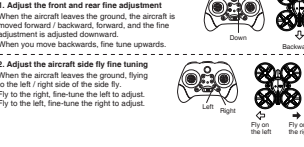

8.0. 360° rollover



When the left joystick (throttle) is pushed up or down, the aircraft turns left or right accordingly.



When the right joystick (throttle) is pushed up or down, the aircraft turns left or right accordingly.



When the right operating lever (direction) is pushed up or down, the aircraft turns left or right accordingly.



When the right-hand lever (direction) is pushed to the left or to the right, the corresponding side fly or fly on the right side of the aircraft.

8.3 Forward 90° roll



8.4 Back 90° roll
Short press the scroll key, and then push the right roller down, the corresponding forward side of the aircraft.

8.5 Forward 90° roll
Short press the scroll key, and then push the right roller down, the corresponding forward side of the aircraft.

Note: Keep the aircraft at a height of 2-3 meters when rolling, so that the aircraft is easier to maintain the height after rolling.

9.0. Headless mode

9.1 Headless mode switching

Start and set: After the completion of the aircraft frequency, the aircraft placed in the flat level, or hover in the air to ensure that the head of the aircraft and the remote control in front of the same level, press the headless mode button (aircraft LED lights flash) Start headless mode.

Exit the headless mode: Press the headless mode button again (aircraft LED is lit), then exit the headless mode.

9.2 One key return

Press the button to return to the channel, you can control the fly with the same one key return. During the return process, press the function key combination on the remote control or push the right joystick "forward" to return the aircraft.

Tips: low alarm

When the remote control appears tapping flashing, indicating that the aircraft is about to run out of power, then the aircraft will automatically return. During the return process, press the function key combination on the remote control or push the right joystick "forward" to return the aircraft.

10.0. Flying environment

Do not use this product in the following environments to avoid accidental injury or damage to the aircraft.

- 1) High-voltage line lots, park lots, railway lots, highway lots and so on
- 2) Thunderstorms weather, windy weather, rain and snow weather.

11.0. End flight

1) manual landing

- 1) first turn off the power of the aircraft, and then turn the remote control power.
- 2) Remove the aircraft from the aircraft.

12.0. Propeller installation method

The propeller of the aircraft is installed with the location requirements, please press the corresponding code to install code as shown below.

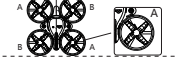

Install the propeller: Hold the small bat of the propeller, press the motor shaft to press it, careful not to deform the propeller.

13.0. troubleshooting

13.1 remote control and the aircraft did not respond to the solution:

- 1) Make sure the code is successful. See page 4 for code method.
- 2) whether the battery is low
- 3) Make sure the remote control is in the original match.

13.2 can not roll the solution:

- 1) Reversing the rollover function key.
- 2) Check whether the lithium battery is too low, re-charge.

13.3 aircraft fuselage solution:

- 1) Check if the propeller is self-loosed and replace the new propeller.
- 2) Turn on the aircraft power to restart.
- 3) Place the aircraft in the horizontal plane to recalibrate the gyroscope.

13.4 Aircraft can not take off the solution:

- 1) Check that the screw is installed correctly.
- 2) whether the aircraft crash cover is loose, tighten the propeller installation.
- 3) Check whether the aircraft has flashing, low power, the lights flashing.

14.0. FPV Troubleshooting

14.1 Goggle display screen No image:

- 1) Check to see if the power supply of the camera is sufficient.
- 2) Check whether the goggle antenna channel and transmitter channel is consistent.
- 3) Check the transmitter and the end of the goggle N/P standard is consistent.

14.2 Goggle received the image quality is poor or wireless transmission distance near:

- 1) whether the same frequency of radio transmission equipment interference. FPV system should choose other frequencies, to avoid the interference frequency or to avoid the use of the same site.
- 2) whether the goggle antenna is installed.
- 3) whether the goggle and the antenna between the mountains, houses, trees and other obstacles, please use the FPV system in the open space.

14.3 Accessories list

